

D-Link DWR-M921

You can apply this procedure on computer, PlayStation, XBOX, Nintendo and any other gaming device

PlayStation 4

In order to solve your PS4 problem please follow the below steps

- **Step 1:** Firstly navigate to the settings menu on your PS4
- **Step 2:** Next select Network
- **Step 3:** You need to select “set up internet connection”
- **Step 4:** You need to select “custom”
- **Step 5:** You need now to select the method in which your PS4 connects to the internet
- **Step 6:** Make sure to set your IP address manually
- **Step 7:** Enter the desired IP address that you would like to use for your PlayStation®4.
 - IP Address: 192.168.0.50
 - Subnet Mask: 255.255.255.0
 - Default Router: 192.168.0.1 (IP Address of your router)
 - Primary DNS: 193.227.177.130
 - Secondary DNS: 194.126.16.38
- **Step 8:** In MTU Settings, select automatic.
- **Step 9:** In Proxy servers , select Do Not Use
- **Step 10:** Select TEST Internet Connection.
- **Step 11:** Connect a device to your D-Link router (using cable / WIFI)
- **Step 12:** In your browser enter the address 192.168.0.1
- **Step 13:** You will be prompted to enter Username: admin and Password: admin
- **Step 14:** Click Features then Firewall
- **Step 15:** Go to Advanced and enable DMZ then type 192.168.0.50 in DMZ Host IP Address
- **Step 16:** Click Save & Apply

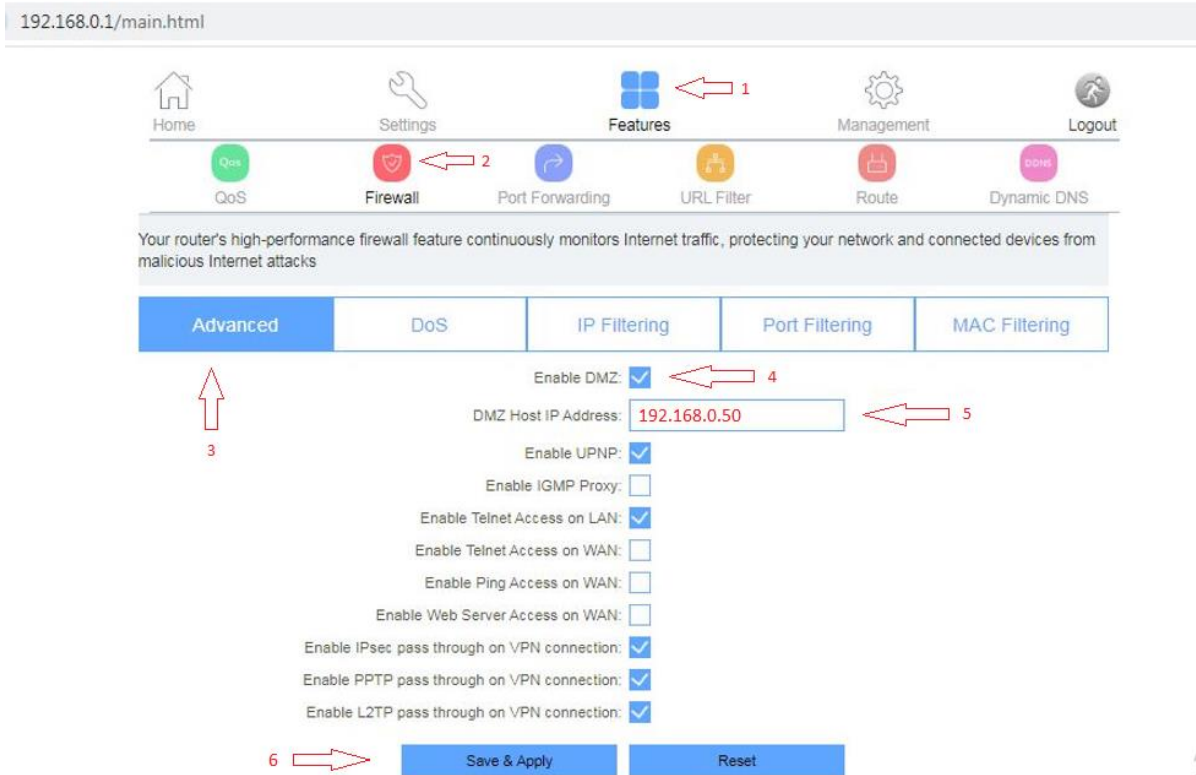

- **Step 17:** Reboot your PS4 and your NAT type problem should be solved

PlayStation 3

In order to solve your PS3 problem please follow the below steps:

- **Step 1:** On your PS3: Go to network settings then Internet connection settings a
- **Step 2:** Choose the type of connection you are using (wired/wireless) then choose Manual IP and enter the following IP addresses:
 - IP Address: 192.168.0.50
 - Subnet Mask: 255.255.255.0
 - Default Router: 192.168.0.1
 - Primary DNS: 193.227.177.130
 - Secondary DNS: 194.126.16.38
- **Step 3:** Disable the UPnP and leave the rest of the setting as they are
- **Step 4:** Connect a device to your D-Link router (using cable / WIFI)
- **Step 5:** In your browser enter the address 192.168.0.1

- **Step 6:** You will be prompted to enter Username: admin and Password: admin
- **Step 7:** Click Features then Firewall
- **Step 8:** Go to Advanced and enable DMZ then type 192.168.0.50 in DMZ Host IP Address
- **Step 9:** Click Save & Apply

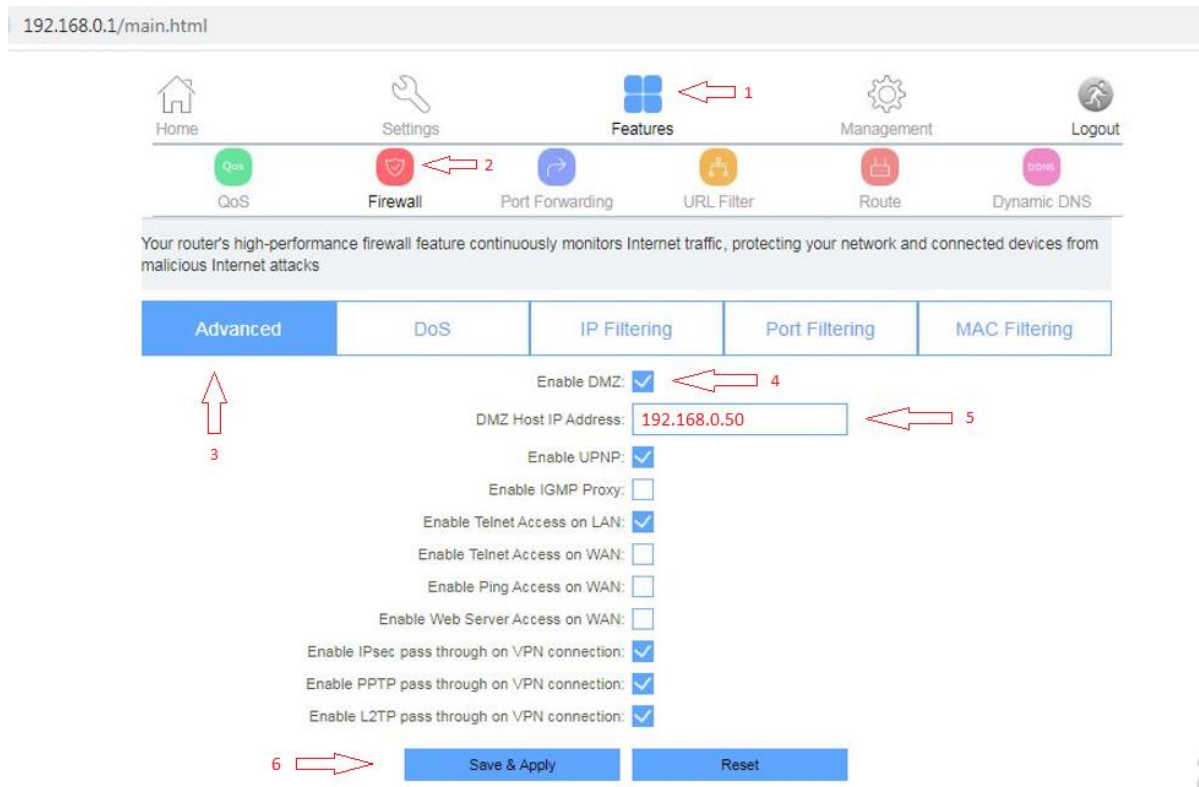

- **Step 10:** Reboot your PS3 and your NAT type problem should be solved

Laptop or Desktop

In order to solve your gaming problem on your computer please follow the below steps

- **Step 1:** Click Start then Control Panel
- **Step 2:** Click on network and internet then network and sharing center
- **Step 3:** When the Network and Sharing Center opens, click on Change adapter settings.
- **Step 4:** Right-click on your local or wireless adapter and select Properties
- **Step 5:** In the Local Area Connection Properties window double-click Internet Protocol Version 4 (TCP/IPv4)
- **Step 6:** Select use the following IP address and enter IPs and Subnet Mask
 - IP Address: 192.168.0.50
 - Subnet Mask: 255.255.255.0

- Default Router: 192.168.0.1 (IP Address of your router)
- **Step 7:** Then enter your Preferred and Alternate DNS server addresses
 - Primary DNS: 193.227.177.130
 - Secondary DNS: 194.126.16.38
- **Step 8:** Connect a device to your D-Link router (using cable / WIFI)
- **Step 9:** In your browser enter the address 192.168.0.1
- **Step 10:** You will be prompted to enter Username: admin and Password: admin
- **Step 11:** Click Features then Firewall
- **Step 12:** Go to Advanced and enable DMZ then type 192.168.0.50 in DMZ Host IP Address
- **Step 13:** Click Save & Apply

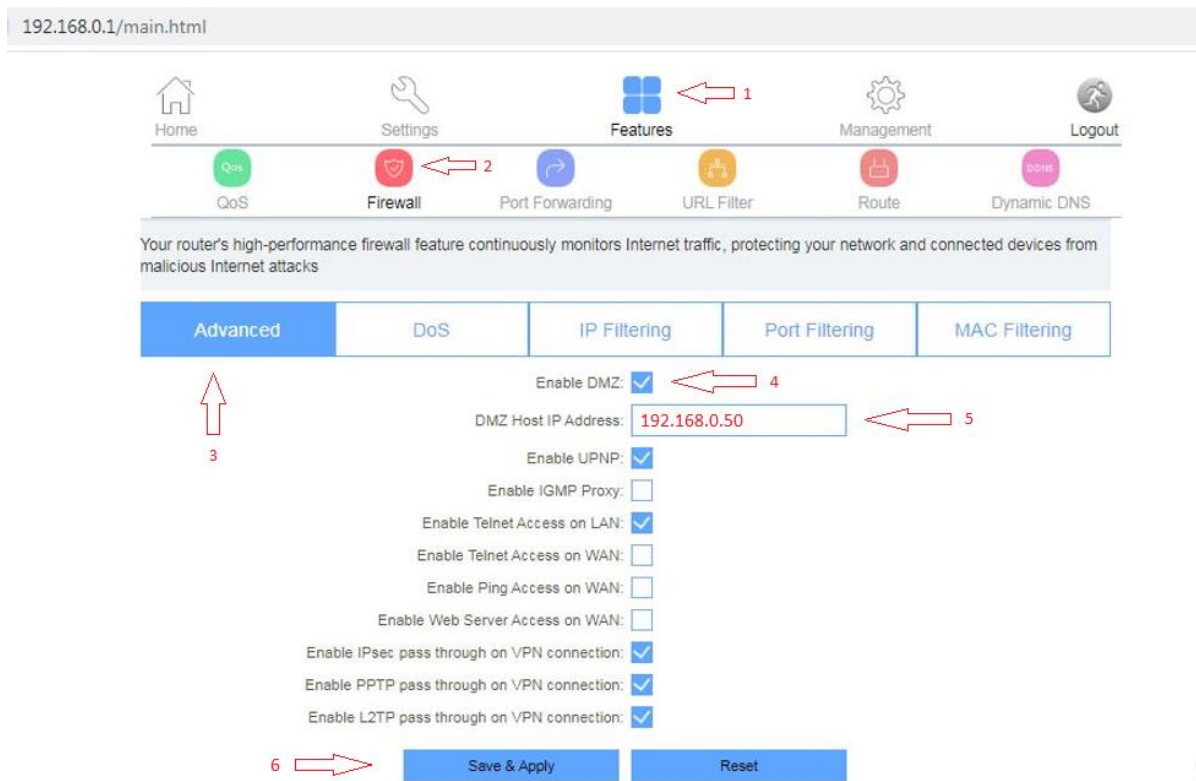

- **Step 14:** Reboot your computer to solve gaming problem.